



# TERRACES

PURSUE NEW PERSPECTIVES



MetLife





---

Pursuing a new perspective begins with prime positioning. It's not where you stand today, but where you advance tomorrow. Put yourself in a new environment designed for balance with room for growth in a central location — at Terraces, we can think of no better pursuit for your business. Rising 11 stories above Atlanta's thriving Central Perimeter submarket, Terraces is a two building, Class A workplace destination.

# PURSUE NEW PERSPECTIVES





## A BUILDING FOR YOUR BRAND

An office at Terraces boasts a choice location and distinct, modernist architecture. Businesses have access to quality talent and are surrounded by fellow A-list tenants, and with close proximity to MARTA, GA 400, and I-285, employees at Terraces enjoy convenient access and shorter commute times.

---



## A PLACE FOR TALENT

With all of the elements for an unrivaled workplace environment, it's no wonder why top companies choose to office here. Terraces delivers a progressive vision for corporate innovators with efficient and flexible 50,000+ RSF floor plates and the unbound potential to create a space that extends your company culture.

---



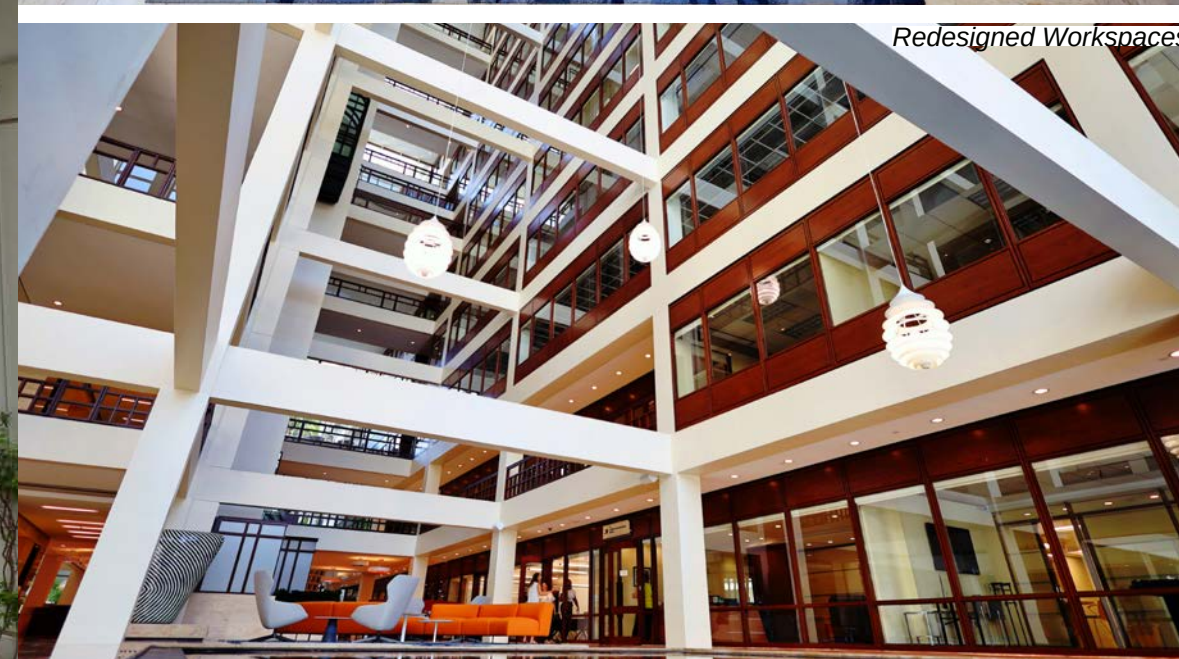

# PURSUE BALANCE

Extensive exterior landscape enhancements join the Terraces North and South buildings for an elevated connection of people and place. Make wellness an integrated part of your day with walks around the lake and ample outdoor gathering space to take the workday outside.



## SPACE DESIGNED FOR WORK AND WELLNESS

Contemporary lobbies create an elevated sense of arrival while on-site fitness center classes, rotating lunch options and a food truck program offer something to look forward to throughout your workday. From abundant communal space for collaborating to a boardroom and conference facility with modern technology, Terraces is more than a workspace - it's an interactive campus community.



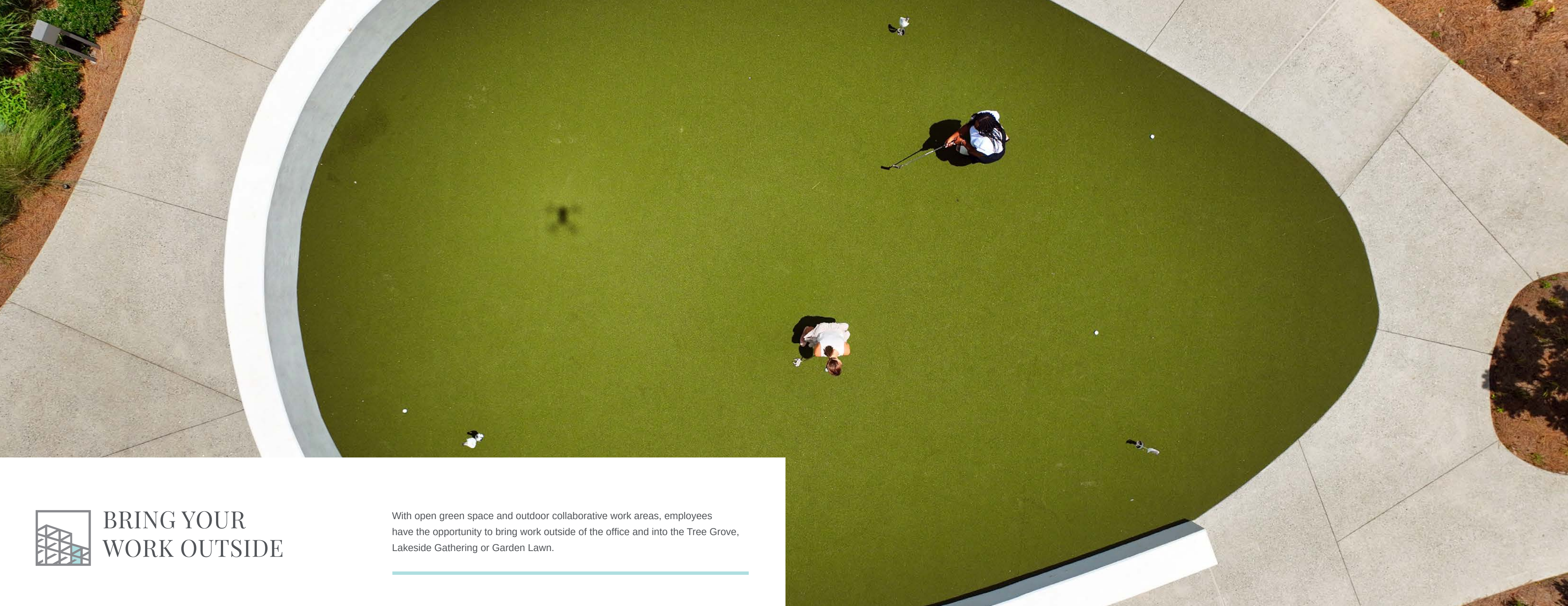

## BRING YOUR WORK OUTSIDE

With open green space and outdoor collaborative work areas, employees have the opportunity to bring work outside of the office and into the Tree Grove, Lakeside Gathering or Garden Lawn.

---





# SHAKE SHACK

## PURSUE CONVENIENCE

Located in the heart of Central Perimeter, Terraces offers an extensive amenity base including countless full service and boutique hotels, locally owned shops and a diverse mix of casual and fine dining restaurants.





## NEIGHBORHOOD ESSENTIALS OUTSIDE YOUR DOOR

A choice location with access for convenient commutes to the grocery store, business services and more. Close proximity to MARTA, GA 400 and I-285. It's all here, and it's yours for the taking.

## VAST AMENITIES

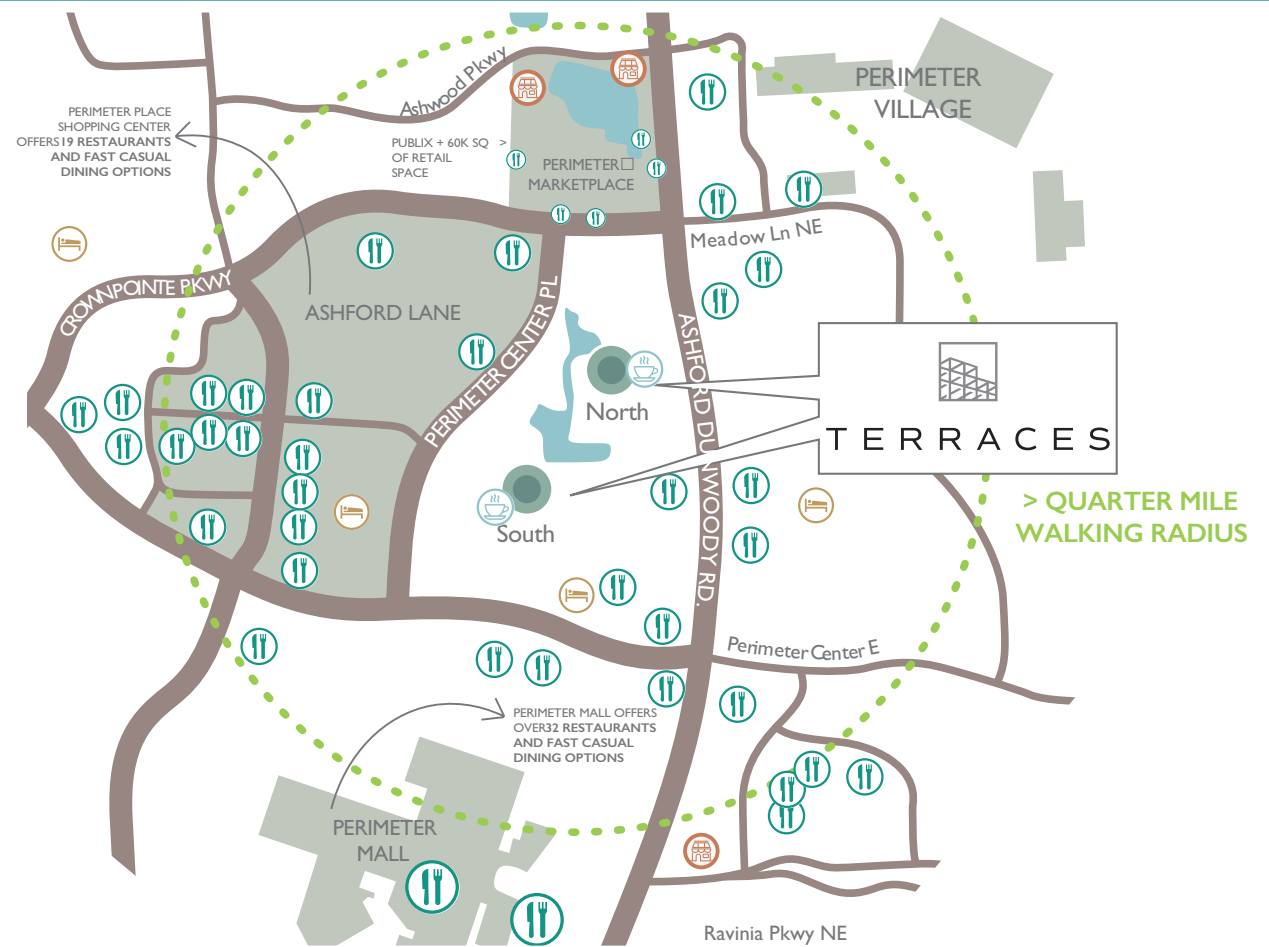

**OVER 20 WALKABLE DINING OPTIONS**  
within a half-mile radius



**DIVERSE LODGING**  
with boutique and full-service options



**CONVENIENT ACCESS**  
to grocery and services





# ACCESS AND COMMUTE HACKS

Enjoy unparalleled access to GA-400 and I-285 with a wide range of alternate back road routes to avoid rush hour traffic.

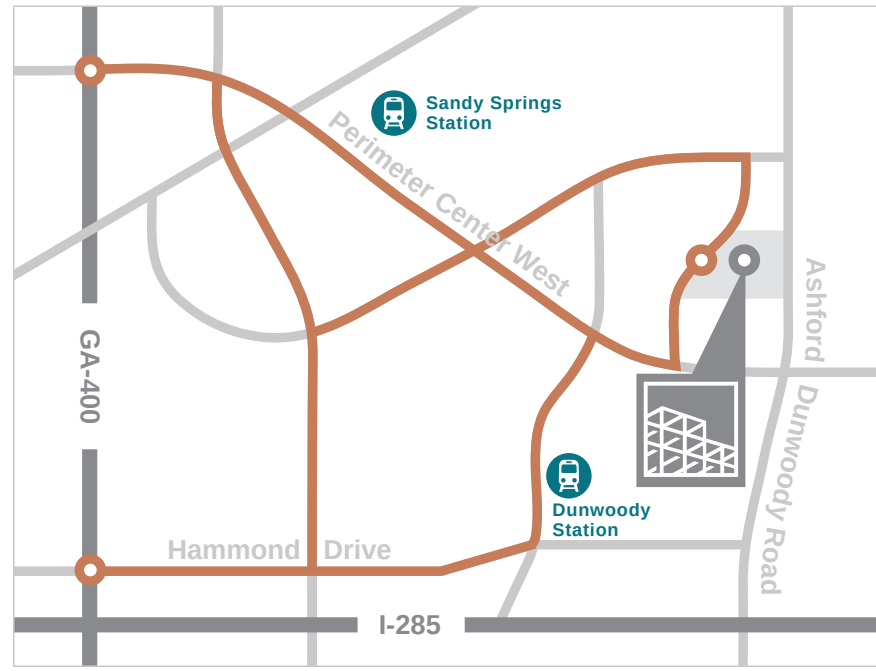

Variable access routes to GA-400

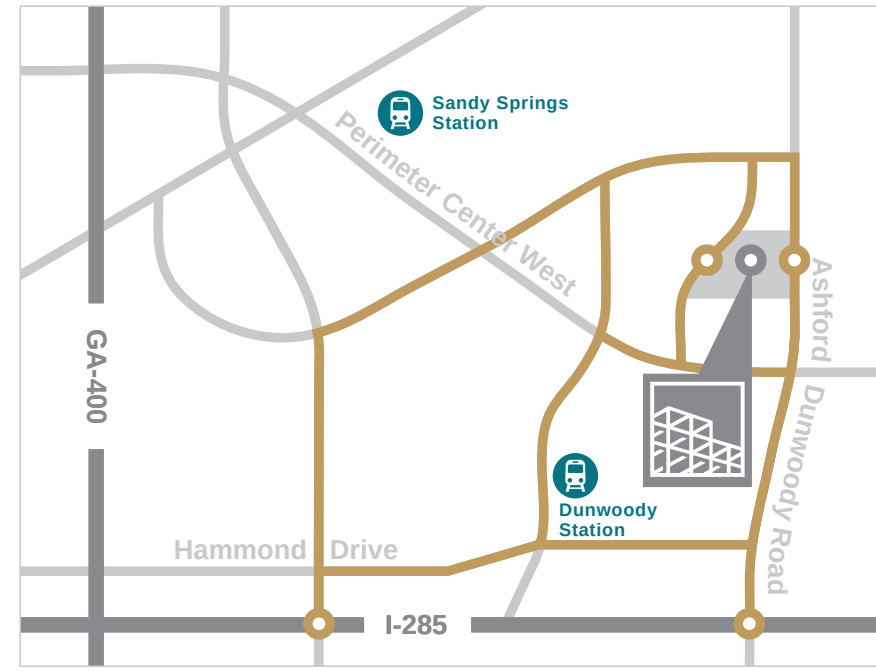

Variable access routes to I-285

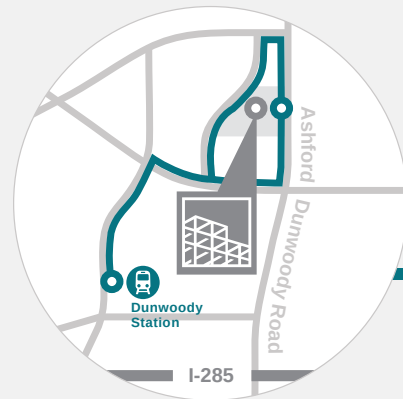

## EXCLUSIVE MARTA SHUTTLE SERVICE

- Departs from Dunwoody MARTA Station
- Arrives every 20-25 minutes
- Morning Route | 6:30 - 10:15 am
- Evening Route | 3:00 - 6:45 pm

# LEVERAGE YOUR POTENTIAL







For more information, please contact:

**Glenn Aspinwall**

Glenn.Aspinwall@am.jll.com

404.995.2139

**Brooke Dewey**

Brooke.Dewey@am.jll.com

404.995.2138



TERRACESATL.COM

 **N O R T H** 400 PERIMETER CENTER TERRACE

 **S O U T H** 115 PERIMETER CENTER PLACE

ATLANTA 30346

Although information has been obtained from sources deemed reliable, neither Owner nor JLL makes any guarantees, warranties or representations, express or implied, as to the completeness or accuracy as to the information contained herein. Any projections, opinions, assumptions or estimates used are for example only. There may be differences between projected and actual results, and those differences may be material. The Property may be withdrawn without notice. Neither Owner nor JLL accepts any liability for any loss or damage suffered by any party resulting from reliance on this information. If the recipient of this information has signed a confidentiality agreement regarding this matter, this information is subject to the terms of that agreement. ©2020 Jones Lang LaSalle IP, Inc. All rights reserved.

Jones Lang LaSalle Brokerage, Inc., a licensed broker in 48 states | +1 404 995 2100 | 3344 Peachtree Rd NE, Atlanta, GA 30326